

Drop-off and Pick-up Planner: Example Public School

325 Adam Ave, Anytown, Ontario

Drop-off:

- Yard supervision begins at 8:45 am.
- All students are expected to be in the school yard by 9:00 am when the entry bell rings.

Pick-up:

- Kindergarten Dismissal at end of day is at 3:00 pm.
- Grade 1-8 Dismissal at end of day is at 3:15 pm.

General Rules:

- **Morning Drop-off:** Please allow Grade 1-8 students to walk to their entry door on their own.
- **Afternoon Pick-up:** Children getting picked up after school will wait at their designated exit.
- **During pick-up and drop off, parents can stop and/or park:**
 - At the Local Community Arena, directly across the street from the school.
 - Along George Avenue, in areas shown on the map below.
 - Do not leave your car unattended in the school bus loading loop off Adam Avenue.

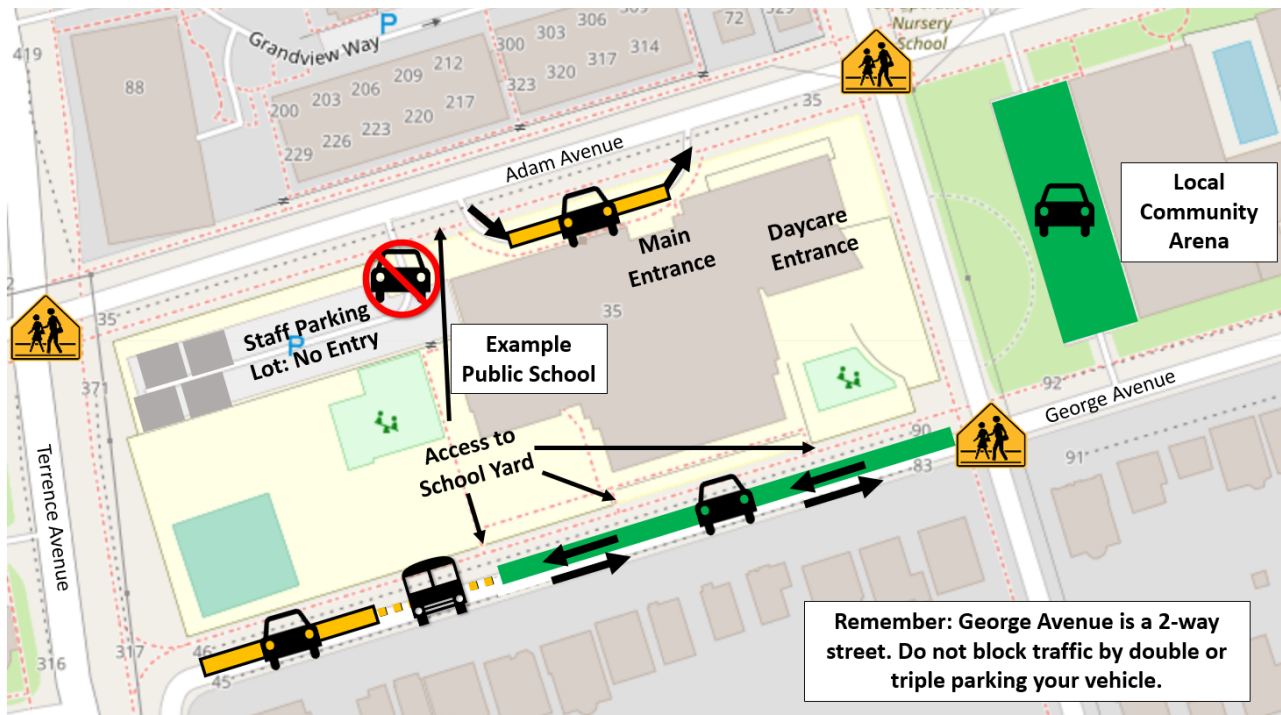

Legend:



Short-term parking allowed
Limited spaces



No Parking
Stopping only to let passengers in/out



School Bus Loading Zone
No Pick-up/Drop-off



School Crossing Guard
Be on alert for crossing students and families



No Entry for Drop-off and Pick-up
Please use alternate options